

# THE MILEAGE BO-O-OSTER-R-R



By **Roadtrek II**  
**Home & Park**  
Motorhomes

75 Ardelt Place, Kitchener, Ontario N2C 2C8 (519) 745-1169



**NEW**  
**UNIQUE**  
**INNOVATIVE**

Truly a cleverly designed, ingeniously and expertly innovated spacious motorhome, equipped and self contained for year round use. Several exciting models to choose from. All offer various seating and sleeping arrangements which are changable in a jiffy for your convenience.

There is optimum counter, cabinet and storage space for cooking and travelling needs, plus room to move around and entertain. Large, comfortable, even and straight beds (for up to six persons), of thick and soft foam, give the restful sleep you expect of quality. The full compliment of features and options opens up the world around you, be it beach, woods or city.

It has the comforts and facilities comparable to home. It's a housekeeping unit on wheels. It is easy to drive and park and offers the convenience of a fixed flush toilet, 31 gallon waste tank, L.P. gas stove, 12,000 BTU furnace, hot water heater, two way fridge, shower with fold away stall and many more exclusive innovations.



*Beds for four adults in front are easily extended and still permit free exit and entry.*

The large picture window brings the outdoors in adding to the already open spaciousness and full ceiling height of the van. For complete privacy the interior can be changed to a large (4 ft.) washroom in the centre and separate compartments for beds in front and rear sections by simply opening the folding closet doors and closing of the peek proof blind type curtains all round.



*Double bed in rear, 74" long, gives undisturbed privacy and direct access to washroom.*

The low, aerodynamic and futuristic roof with translucent cockpit windows is insulated and finished with a soft ceiling liner. Most vans have a radio, gas saving engine, cruise control, power steering and brakes. Radial steel belted tires and stabilizer bar assures you of a smooth comfortable ride. Bright finish mirrors, bumpers, hub caps and decorative accent striping enhance the appearance. The single rear door with one large window provides a better unobstructed view.



*Relax in comfortable swivel, sliding and reclining seats. Clover leaf dinette table folds to cocktail size and swivels out of the way for extra space and easier moving around.*



*Just open privacy doors on left for toilet, coats and shower. Dinette converts to large double bed, having lots of storage space below and in cabinets above. Horizontal snug fitting curtains on vertical tracks at curved sides of windows keep the smallest sun ray out, make looking in at night impossible and are out of the way when up.*

Five **Roadtrek II** Maxivan packages especially selected in order of price range to suite anyone's personal needs and pocketbook or alternatively make up your own custom package from the options offered.

## 'THE ECONOMIZER'

This maxivan has a gas saving engine, power steering, windows in all doors and all other standard automotive equipment. The conversion includes a fibreglass roof and finished interior of walls, curtains, ceiling, carpet, seats, table, double bed and all cabinets. Fixtures and appliances may be added later at any time, if you're handy do it yourself and save.

## 'THE STANDARD'

Has a powerful engine and much optional automotive equipment like automatic transmission, power brakes and steering, cruise control, radio, stabilizer bar, steel belted radial tires, etc. Conversion is complete including all standard fixtures and appliances like sink, pump, stove, furnace, fridge, extra battery, etc.

## 'THE POPULAR'

As the name implies this package is most popular. In addition to the many automotive options and all standard fixtures and appliances it also includes many conversion options like roof vent with screen, sunken floor, fixed toilet, holding tank, galley window with shutters and exterior decorative accent striping.

## 'THE VERSATILE'

In addition to having the features and options of 'THE POPULAR' this package accommodates sleeping for four persons. The rear dinette converts to a large double bed and the front lounge to two single beds. To assure complete privacy for the three separate compartments in front, centre and rear, simply close and lock the two sets of folding doors.

## 'THE TOP LINER'

Features a roomy shower with fold away stall and sit-up tub combination. Also two large double beds, one in rear and the other above the front lounge thereby permitting free exit and entry and room to move around. A direct ignition 6 gal. water heater and furnace and 46 gal. of water capacity is included, plus many more options too numerous to list here.



## Roadtrek II

Maxivan 127" WB

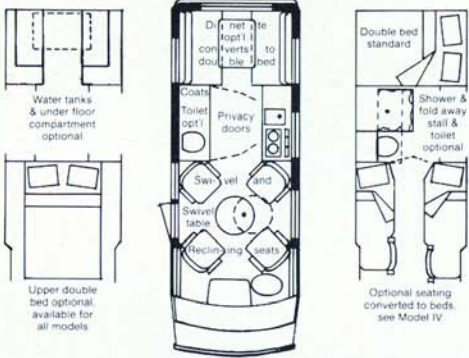

A smooth riding and spacious vacationer for accommodation and meal saving family travel, be it beach, woods or city. Makes trips and outings with youngsters a breeze. Sleeps two, four or six, if so equipped.

## Roadtrek III

Standard Van 127" WB

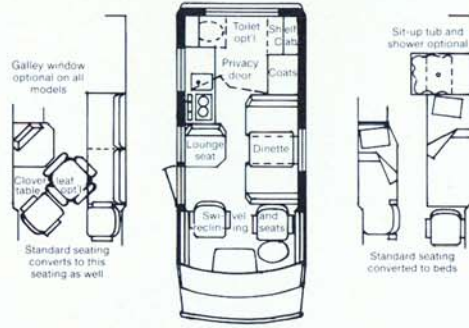

A midsize favourite, perfect for a couple but with upper bed is more than sufficient for a family of four. The popular side dinette converts to a chesterfield and by turning the front seats, the grouping then forms a conversation cluster. Stop to eat, drink or just rest at anytime. A van can park almost anywhere for overnight.

## Roadtrek IV

Short Van 109" WB

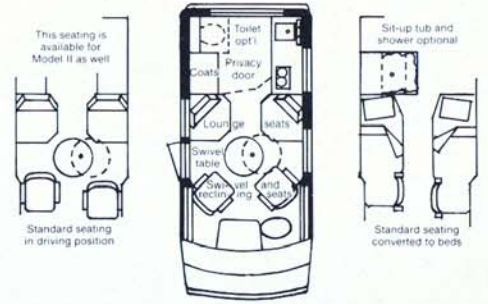

Compact, swift and sporty, an ideal car substitute for every day transportation. Sleeps 2 (or if upper bed 4) for weekend or longer trips, year round to lakes and parks in summer, skislopes and sunny south in winter. Special storage for skis, poles, fishing rods and other long objects inside. Convenient and flexible, no reservation worries, suitcases to pack or lug around.



4' x 4' private washroom, 40" x 25" shower with fold away stall and sit-up tub in closet. To use shower simply pull and swing out coats on hangers, while they remain in place on rod fixed to shelf above, all together as one unit to rear over seat or bed. Next fold down shower pan and extend curtain, which is hanging stored behind coats on knobs at ceiling, forward to knobs in van centre.

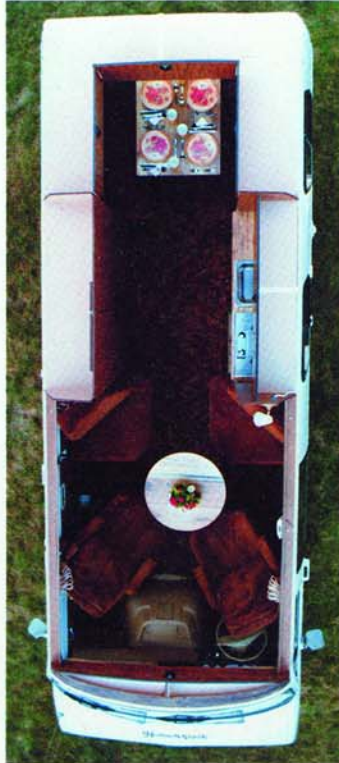

Completely open for every day living, entertaining visitors or just relaxing.

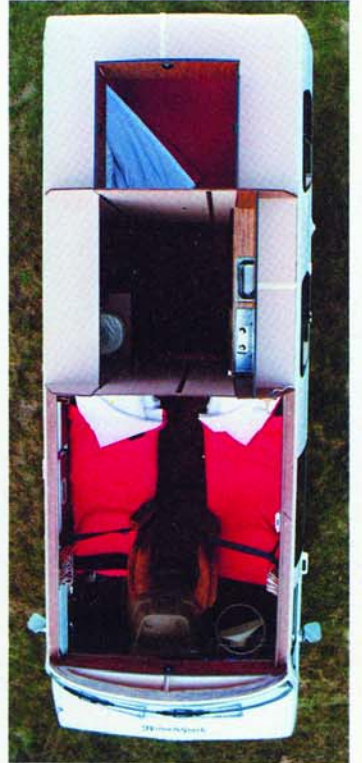

Simply open the two double closet doors to make the three private compartments.

### STANDARD CONVERSION FEATURES

#### MODEL

	II	III	IV
1 Vinyl woodgrain interior, insulated	•	•	•
2 Curtains all around on marine track	•	•	•
3 Dinette — 24" x 30" table, (converts to single bed, chesterfield, conversation lounge)	•	•	•
4 Fixed double bed, thick and soft foam mattress	•	•	•
5 Lounge seat, belt, (converts to single bed)	•	•	•
6 Swivel and reclining seat, belt, (24" round table, one)	4	2	2
7 Coat Closet, 25" wide, 52" high	•	•	•
8 Privacy area by opening closet folding doors	•	•	•
9 Linen closet, 60" high, 5 shelves	•	•	•
10 Overhead cabinets, (storage under fixed seats)	•	•	•
11 Sound equipment housing over windshield	•	•	•
12 One deep drawer and a cutlery drawer under stove	•	•	•
13 Sink, faucet, 12V electric water pump (compare size)	•	•	•
14 City water and 110 volt connections	•	•	•
15 Auxiliary battery, (isolator, 12V lites)	•	•	•
16 110V receptacle, florescent and bullit lites	•	•	•
17 Fresh and waste water tanks, 9 and 5 imp. gal.	•	•	•
18 Two burner L.P. gas stove (built-in)	•	•	•
19 12,000 B.T.U.— L.P. gas furnace	•	•	•
20 48 lbs. L.P. gas tank, automatic shut-off, access door	•	•	•
21 Two way fridge, 12/110 volt, 2.5 c. ft.	•	•	•

C.S.A. approved materials and equipment are used and may exceed required installation standards on many items.

### OPTIONS

	MODEL II	MODEL III	MODEL IV
31 Dinette — 24" x 30" table, seat cushions, converts to double bed	•	•	•
32 Lounge seat, belt, (converts to single bed)	•	•	•
33 Upper doubled bed, two — 24" x 72" x 2" mattresses	•	•	•
34 Cabinet over windshield	•	•	•
35 Clover leaf table, 34" x 34", when retracted 23" x 23"	•	•	•
36 Swing-out coat closet and shelf above	•	•	•
37 Raisable floor in front area 33" x 22"	•	•	•
38 Shelf cabinet behind toilet	•	•	•
39 Refuse bag holder on inside of counter door	•	•	•
40 Direct ignition furnace (may require drawer also)	•	•	•
41 Galley window with sliding shutters	•	•	•
42 Roof vent, 14" x 14" (indicate if 12V fan is wanted)	•	•	•
43 Roof sun port, 26" x 14"	•	•	•
44 Hooded power exhaust fan over stove (12 volt)	•	•	•
45 Recessed entrance step, (portable entrance step)	(•)	(•)	(•)
46 Under floor storage 24" x 12" (4") x 6"	(•)	(•)	(•)
47 Under floor compartment 34" x 20" x 10" or 33" x 24" x 13"/10"	•	•	•
48 Sunken floor in centre, 71" (52") x 34" x 5"	•	•	(•)
49 Sunken floor at rear door, 34" x 20" x 5"	•	•	•
50 31 amp 110/12 volt converter with charger	•	•	•
51 Additional battery(s) and holder(s)	•	•	•
52 12 volt receptacle, extra 12V lite(s)	•	•	•
53 Interior L.P. gas and battery gauge(s)	•	•	•
54 Two way fridge, 12 volt/L.P. gas, 1.7 c. ft.	•	•	•
55 Fixed flush toilet (Note: If enclosure forward)	•	•	•
56 Waste tank, 31 or 19 Imp. gal., (8 Imp. gal.), 13 Imp. gal.	•	•	(•)
57 Fresh water tank, 12, 18, (28) Imp. gal.	(•)	•	•
58 Sit-up bath tub and shower	•	•	•
59 Direct ignition L.P. gas water heater, 6 gal.	•	•	•
60 Exterior decorative accent striping	•	•	•
61 Spare tire, rim, cover and carrier	•	•	•
62 Automotive air conditioning	•	•	•
63 110 volt roof air conditioning	•	•	•
64 Whitewall tires	•	•	•
65 L.P. Gas Detector (12 volt)	•	•	•
66 12" x 24" mirror on closet door	•	•	•

Certain options may require other options or deletions of standard items in order to function properly. Exclusive and original roof and interior design, may not be duplicated. Patent and copy right applied for. Specifications and design are subject to change without notice or obligation whatsoever, and we shall not be responsible for the delivery or non delivery of any item herein.

Authorized Dealer: